

The background features a world map with a grid overlay, transitioning from dark blue at the top to light blue at the bottom. The map is centered on the Atlantic Ocean, showing the Americas on the left and Europe and Africa on the right.

INTERNATIONAL HEALTH FACILITY GUIDELINES



www.healthdesign.com.au/iHfg

WHAT IS iHFG?

TAHPI, the International specialist firm of Health Planners and Health Facility Designers is pleased to introduce you to the International Health Facility Guidelines (iHFG).

iHFG provides comprehensive ready-made briefing and design guidelines that includes:

- Over 50 Functional Planning Units (FPU's) or Departments
- Generic Schedules of Accommodation (SOA's)
- Over 500 Standard Components Room Data Sheets (RDS's)
- Over 500 Standard Components Room Layout Sheets (RLS's)

WHY USE iHFG?

The Guidelines are divided into several parts and are easy to follow.

Users may download the guidelines in large PDF file bundles, or select only the relevant parts and associated components to suit their needs.

Health Design requires the management and manipulation of vast amounts of data.

iHFG provides the opportunity to distribute ready-to-use standards as well as briefing and design documents such as the traditional Room Data Sheets (RDS) and Room Layout Sheets (RLS) as templates for new projects.

These can make the initial project briefing, documentation and costing easier, quicker and more accurate.

CUSTOMISE iHFG'S TO SUIT YOUR COUNTRY

Many countries have already adopted and customised the (iHFG's) to suit their specific needs.

A consultation process to fine tune the iHFG for the specific requirements of a country, ready for adoption by the Health Authority can generally be completed in 6 months including approvals. iHFG guides designers and health officials alike to provide competent healthcare facilities quicker, with minimal errors or mis-interpretation.

The screenshot shows the iHFG website interface. At the top, there are navigation tabs: Guidelines, Standard Components, HFBS, Schedules, and Contacts. Below this is a 'Shopping Cart' icon with a '0' next to it. The main content area is titled 'Guidelines' and contains several sections of text, including 'Our Mission' and various 'Part' descriptions (Part A through Part W). At the bottom, there is a table titled 'Guideline Sections' with columns for 'Section', 'Size', 'Price', and 'Download' buttons. The table lists parts A through Q, with some parts marked as 'Revised' or 'New'.

Guideline Sections	Size	Price			
Part A - Administrative Provisions	1.5mb	Free	View Index	Preview	Download
Part B - Health Facility Briefing and Design	9.3mb	Free	View Index	Preview	Download
Part C - Access, Mobility, OH&S	1.5mb	Free	View Index	Preview	Download
Part D - Infection Control	1.1mb	Free	View Index	Preview	Download
Part E - Engineering Services and Environmental Design	67.3kb	Free	View Index	Preview	Download
Part F - Feasibility Planning & Costing Guidelines	175.0kb	Free	View Index	Preview	Download
Part Q - Equipment Planning Guidelines	449.4kb	Free	View Index	Preview	Download



EXAMPLES

Some examples of customisation of iHFG includes India and United Arab Emirates.



Dubai



Abu Dhabi



India



Saudi Arabia



Papua New Guinea



Sharjah Healthcare City



Somali(UNICEF)



Sultanate of Oman

The Standard Design Components of the iHFG are free in PDF format but also available in editable CAD or Revit formats. iHFG can be used directly with the popular web based Health Facility Briefing System (HFBS) software together with many tools and modules for customising them.

HFBS is available here: www.healthdesign.com.au/infohub

IHFG FRAMEWORK

SOA . RDS . RLS . FLOW DIAGRAMS

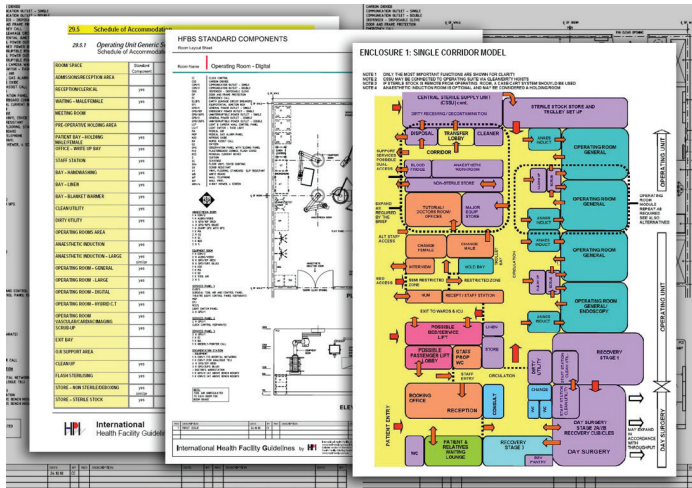

Part A – Administrative Provisions

This part outlines the licensing process for healthcare facilities and prequalification process for design consultants

Part B – Health Facility Briefing and Design

This part includes Planning & Design guidelines including Functional Planning Units (FPU) or Departments. Each FPU provides a Description, Models of Care, Functional Relationships and generic Schedules of Accommodation (SOA). Unique room types are defined as Standard Components and provided as Room Data Sheets (RDS) and Room Layout Sheets (RLS).

Part C – Access, Mobility, OH&S

This part includes the requirements for Access, Mobility, Occupational Health, Safety and Security.

Part D – Infection Control

This part details the Infection Control requirements of healthcare facilities.

Part E – Engineering

This part focuses on the acceptable International engineering guidelines and standards for Mechanical, Electrical, Plumbing, Fire and other building services.

Part F – Feasibility Planning & Costing

This part includes feasibility planning, capital costing, financial appraisal and procurement strategy.

Part Q – Equipment Planning

This part covers the methodology for the planning, procurement & placement the Furniture Fittings, Fixtures & Equipment (FF&FE) both Medical and Non-medical.

Part S – Health Service Planning

This part includes catchment identification, service definition, needs assessment, demand projections, gap analysis and service profiling.

Part W – Wayfinding

This part provides an introduction to wayfinding and design principles.

RDS

The Room Data Sheets (RDS's) represent the detailed briefing requirements of individual room types. Some RDS's provide options for certain elements such as materials. If an external document refers to these RDS's, without qualifying the choice of options, then the default options will prevail. In case of any discrepancy between various documents, the RDS's will take precedence.

Where materials or elements are mentioned by generic type (eg Vinyl), the requirements may be satisfied by other materials and elements which have very similar properties (eg impervious sheet flooring).

IHFG Standard Project		Mission: Version 4		Room Data Sheets	
Department	IHFG Standard Components	Room Type	1802	Room Code	18R-BA-201
Room Name	1 Bed Room - Standard, 20m ²				
Net Room Area - Finished	23.5402				
No. of Rooms	1				
Subtotal of Finished Area	23.5402				
Hours of Operation	24 Hours				
Occupancy	2 persons, 10 seats, 10 visitors				
Also consult these Rooms					
Description/ Special Requirements	<p>1 Bed Room - Rooms will accommodate one patient in the absence of family, medical staff and visitors to provide the needs of patients, visitors and staff. Rooms will be furnished with the following items:</p> <ul style="list-style-type: none"> 1. Bed 2. Bedside table 3. Bedside chair 4. Bedside cabinet 5. Bedside table 6. Bedside chair 7. Bedside cabinet 8. Bedside table 9. Bedside chair 10. Bedside cabinet 11. Bedside table 12. Bedside chair 13. Bedside cabinet 14. Bedside table 15. Bedside chair 16. Bedside cabinet 17. Bedside table 18. Bedside chair 19. Bedside cabinet 20. Bedside table 21. Bedside chair 22. Bedside cabinet 23. Bedside table 24. Bedside chair 25. Bedside cabinet 				
Amendment	23.06.2014 - First Draft				

IHFG Standard Project		Mission: Version 4		Room Data Sheets	
Department	IHFG Standard Components	Room Type	1802	Room Code	18R-BA-201
Room Name	1 Bed Room - Standard, 20m ²				
Net Room Area - Finished	23.5402				
No. of Rooms	1				
Subtotal of Finished Area	23.5402				
Hours of Operation	24 Hours				
Occupancy	2 persons, 10 seats, 10 visitors				
Also consult these Rooms					
Description/ Special Requirements	<p>1 Bed Room - Rooms will accommodate one patient in the absence of family, medical staff and visitors to provide the needs of patients, visitors and staff. Rooms will be furnished with the following items:</p> <ul style="list-style-type: none"> 1. Bed 2. Bedside table 3. Bedside chair 4. Bedside cabinet 5. Bedside table 6. Bedside chair 7. Bedside cabinet 8. Bedside table 9. Bedside chair 10. Bedside cabinet 11. Bedside table 12. Bedside chair 13. Bedside cabinet 14. Bedside table 15. Bedside chair 16. Bedside cabinet 17. Bedside table 18. Bedside chair 19. Bedside cabinet 20. Bedside table 21. Bedside chair 22. Bedside cabinet 23. Bedside table 24. Bedside chair 25. Bedside cabinet 				
Amendment	23.06.2014 - First Draft				

IHFG Standard Project		Mission: Version 4		Room Data Sheets	
Department	IHFG Standard Components	Room Type	1802	Room Code	18R-BA-201
Room Name	1 Bed Room - Standard, 20m ²				
Net Room Area - Finished	23.5402				
No. of Rooms	1				
Subtotal of Finished Area	23.5402				
Hours of Operation	24 Hours				
Occupancy	2 persons, 10 seats, 10 visitors				
Also consult these Rooms					
Description/ Special Requirements	<p>1 Bed Room - Rooms will accommodate one patient in the absence of family, medical staff and visitors to provide the needs of patients, visitors and staff. Rooms will be furnished with the following items:</p> <ul style="list-style-type: none"> 1. Bed 2. Bedside table 3. Bedside chair 4. Bedside cabinet 5. Bedside table 6. Bedside chair 7. Bedside cabinet 8. Bedside table 9. Bedside chair 10. Bedside cabinet 11. Bedside table 12. Bedside chair 13. Bedside cabinet 14. Bedside table 15. Bedside chair 16. Bedside cabinet 17. Bedside table 18. Bedside chair 19. Bedside cabinet 20. Bedside table 21. Bedside chair 22. Bedside cabinet 23. Bedside table 24. Bedside chair 25. Bedside cabinet 				
Amendment	23.06.2014 - First Draft				

RLS

The Room Layout Sheets (RLS's) are indicative plan and elevation templates illustrating an example of good design. The RLS shown are deemed to satisfy these Guidelines. Alternative layouts and innovative planning shall be deemed to comply with these Guidelines provided that the following criteria are met:

Compliance with the text of the Guidelines

- Minimum floor areas as shown in the schedule of accommodation in each FPU
- Heights and dimensions where shown
- Any Clean/ Dirty separations shown or implied
- Accessibility to and around various objects
- Relative location and empirical dimensions of:

- Hand rails and Grab rail
- Call points, Power, Light Switch, Data and Gas outlets
- Bed Screens
- Sanitary Fixtures

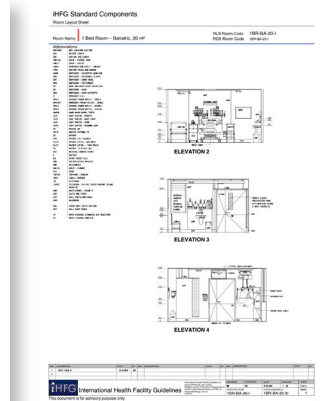
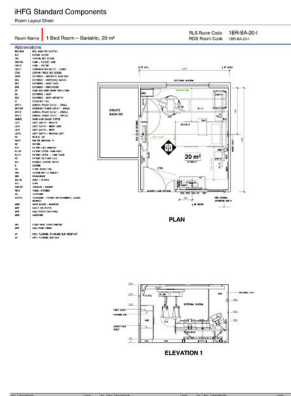

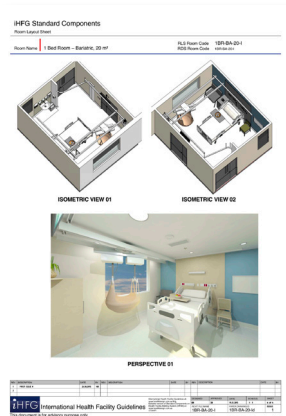
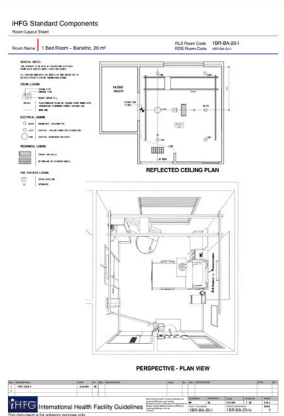

iHFG is available on the Web, on IOS and Android devices. Just search for iHFG.



Schedule of Accommodation(SOA) with areas

www.healthdesign.com.au/ihfg
www.healthfacilityguidelines.com/Apps/iHFG

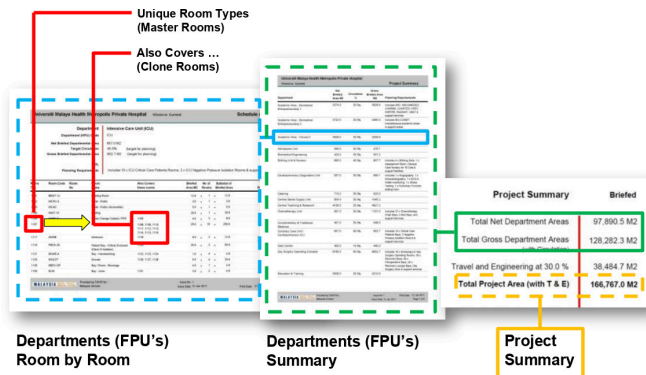

TAHPI WORLDWIDE

- Author and publisher of the International Health Facility Guidelines for 19 years
- International Specialist firm of Health Planners
- High Value Adding Planning, Briefing & Design
- Operating from 23 Countries
- Over 250 Specialist Staff
- Accredited Health Plannign Education Provider

TAHPI
Suite 401, Level 4, Building 25
Dubai Healthcare City, P.O. Box 27801
Dubai, United Arab Emirates

Phone: +971 4 4281348
Email: ihfg@tahpi.net
www.tahpi.net